

O'ConnorTM RV Hopper

Life's a journey, not a destination.



look what's new in RVs'

www.oconnorrv.com

O'CONNOR RV CHILLIWACK
44430 Yale Road
(just off Highway #1)
Chilliwack 604 792-2747



Holiday Trails Resorts

www.holidaytrailsresorts.com

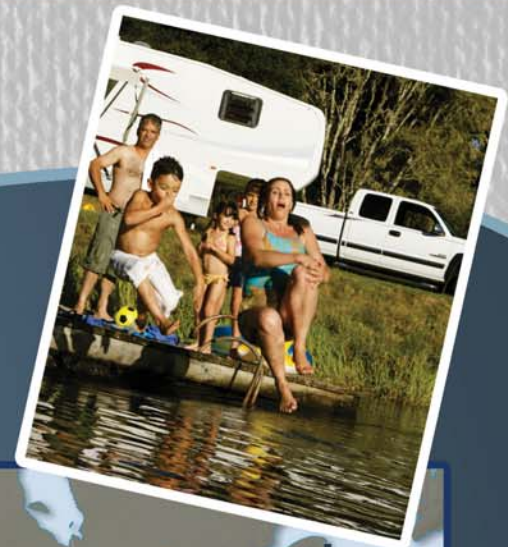

CANADA'S LARGEST RV RESORT SYSTEM

British Columbia

- Camperland, Chilliwack
- Country Maples, Chemainus
- Christina Pines, Christina Lake
- Cumberland Lake Campground, Cumberland
- Desert Skies, Osoyoos (purposed)

Alberta

- Bridgeview, Lethbridge
- Dinosaur Trail, Drumheller

Washington

- The Cedars, Ferndale



Living the dream...

For more information on public and membership camping call **1 800 663 2265**

4
5
6-7
8-9



Message From the President ●●●●●●●●●●

John O'Connor is loving life at the O'Connor Group. Almost everything he does in terms of business revolves around wheels.



Citation ●●●●●●●●●●

Canada's true all-season RV! Proudly manufactured in BC.



Triple-E ●●●●●●●●●●

When your life includes exploring fresh landscapes, Triple E has a model with all the amenities and living space to suit your needs.



Fleetwood ●●●●●●●●●●

See the country without leaving home. Sophisticated décor, top-of-the-line components and quality construction makes owning a Fleetwood such a joy.

O'Connor RV **Hopper**

10
11
13
14
15



What's With the Rules? ●●●●●●●●●●

Unsure about RV regulations for towing? Have a question or two about weight ratios? Read on and become an informed and safe RV owner.



Carriage ●●●●●●●●●●

Luxury 5th wheels...possibly the world's finest!



Northern Lite ●●●●●●●●●●

Northern Lite holds the distinction of producing North America's only truck camper to achieve a five star rating for nine years running.



Sand Storm ●●●●●●●●●●

At Forest River, our design team is always working towards improving the Toy Hauler of tomorrow.



Pleasureway ●●●●●●●●●●

The Class B Motorhome with Class A style!



Publisher: O'Connor RV Chilliwack

Editor: Kathie Nickel Contributing

Writers: BC Recreational Vehicle

Assoc., Go RVing Canada

The Hopper is published yearly by

O'Connor RV. Print and design by

Focus Media Group Office: 338,

151-32500 South Fraser Way,

Abbotsford BC V2T 4W1 Phone:

604.807.2018 E-Mail:

ads@focusmediagroup.ca

Any statements made, expressed or

implied in the Hopper are solely

those of the columnists or manufac-

turer and do not represent the edi-

torial position of the publisher, who

does not accept responsibility for

such statements.

John O'Connor is Loving Life at the O'Connor Group

By Mark MacDonald

John O'Connor says he has oil in his veins. His father Tom did in Australia, and so does John's son, Shane. That's not surprising, as they've all grown up in the automobile industry, and almost everything they do in terms of business revolves around wheels.

Under the O'Connor Group umbrella are: O'Connor Chrysler, O'Connor RV Chilliwack, O'Connor RV Langley, O'Connor Collision and Glass, O'Connor Towing and O'Connor Rapid Lube. "I've tried to maintain a close relationship between all the businesses, so that one helps the other," says O'Connor.

Business is jumping, liter-

ally and figuratively, as all O'Connor logos feature a kangaroo, in recognition of John's Australian roots. "We've maintained a kangaroo as part of our logo, which is on everything that we do," he says. "It's a little identifier that ties us to our heritage." Business has been strong. "It's fantastic," he says. "Our growth has been quite fascinating. It's been steady, and it's all been fun. I love what we do."

O'Connor's father was an automobile dealer in Australia, and John incorporated his first company as O'Connor Motors Ltd., to honour the name of his father's business. John was a field manager for North Queensland for the Ford Motor Company before migrating to Canada in 1976, where he served as BC Sales Manager for Toyota. He managed to purchase Chilliwack's Toyota dealership in 1976. Then in 1979, he acquired

the Dodge franchise for Chilliwack, and O'Connor Chrysler was born.

"We were also selling RV's from the dealership, small motor homes - Little Chiefs - which were built in Chilliwack," he recalls. "The RV business continued to progress and develop, and we had to find a new home for it." That's when they moved O'Connor RV to Yale Road, which runs adjacent to the freeway in Chilliwack. He bought the property with no money down, along with "strong promises about payments, and commitments," he says. "It's great when people believe in you, that you will keep your promises."

Like most every business person in BC, O'Connor found it rough sledding through the recession of the early 1980's. "There was a fair amount of stress," he recalls. "There was wild inflation, with interest rates at 22%, and no profitability." They added a body shop,

and now O'Connor Collision is 20 years old. It's been so successful that the O'Connor's are adding another 14,000 square feet to the 8,000 square foot existing building. "Architecturally, it's going to look great," he says. "The new design will re-enhance the old, and incorporate a totally new building that will be able to service cars, trucks and RV's with offices and staff facilities."

O'Connor entered the tow truck business six years ago, and today, the O'Connor Towing fleet includes seven vehicles and two highway tractors.

Along the way, O'Connor purchased another RV Dealership on the Langley by-pass and O'Connor RV Langley has developed and grown for 12 years.

The O'Connor Group has 120 employees, and John is pleased to note that 46 have been with the company for over 5 years and 24 for over 10. "I think it's

pretty amazing," he says. "We try to cultivate an environment where people like to work, and where they excel beyond their expectations." "If I make it a place where I love to work, I think they will love it too."

John's son Shane has worked in the vehicle business almost all his life. He started at the Collision Centre, was General Manager of the Langley RV store and then moved to Chilliwack to become General Manager of O'Connor Chrysler and Vice President of the Group. Plans are in hand to expand the Chilliwack RV Centre. Larger service facilities are a necessity with the market growth. The stronger Canadian dollar has dramatically improved the price of new recreational vehicles. Affordability at the factory level of pricing is driving the sales to new unimagined levels. Canadians are having fun buying and using RV's and O'Connor RV plans on being part of this great future.



John O'Connor



THE HOPPER

P R E S E N T E D B Y O ' C O N N O R R V



canada's true all-season RV...!!



CITATION travel trailers

Don't let the cold weather get in the way of enjoying your home on wheels all year long. Only General Coach has 57 years of experience to provide every aspect required to enjoy all-season comfort. That's why we are thrilled to offer you the **General Coach Polar-Pak—North America's best Sub-Zero solution!** We back this with an industry-leading six-year limited structural warranty and we are **the only manufacturer that warrants full-time living guaranteed to -30° C.** Ask that from the competition!!

Check out these all-season features before you consider purchasing—don't settle for anything less!

- Holding tanks are suspended within an insulated steel-framed (not plastic) compartment with forced air heat direct from furnace.
- Drain valves and handles are located within an insulated steel compartment.
- Solid wood constructed walls, roof and floor do not conduct cold, heat and moisture like non-insulated aluminum tube framing.

CITATION 5th wheels

- "Stormtite"—The industry's best thermopane window made in Winnipeg.
- Exclusive powered attic vent system controls air circulation within the residential insulated trussed roof.
- Energy efficient Excalibur furnace (triple slides have 2 furnaces - 68,000 btu). **No better system in the industry!**
- Rain sensor Fantastic vent fan controlled by wall thermostat. Fantastic vent fan in bath/bed-room models 29 and larger.
- Daylitter residential skylights with exclusive moisture control are used in thousands of quality homes across Canada. Lifetime warranty.
- XT 16 gas/electric water heater provides 16 gal. of hot water.
- Slide floors (the industry's thickest) are insulated and steel reinforced.
- In-cabinet heat ducting for even heat distribution—no ducts to step on or gather dust.
- Vacuum laminated fibreglass walls with high density foam insulation—non-toxic.
- 100" wide body design—more spacious interior, bathroom and hallways.

- Proven superior resale value—a buying decision you'll never regret!
- General Coach is proud of our 99% customer satisfaction record.**
Visit us at www.generalcoach.bc.ca

POLAR-PAK
THE SUB-ZERO SOLUTION

"I bought this fifth wheel to live in, it gets d... cold up here in Fort Nelson, BC. It had been -35 to -40 C for two to three weeks and I was still toasty warm. There are cheaper trailers, but if you need one that's well built and can withstand cold, this is the baby for you".

L.K. Fort Nelson, BC



Citation

CITATION

WWW.OCONNORRV.COM

NOTES

Blank lined area for notes.

6

follow your dream!

When your lifestyle includes exploring fresh landscapes along the open road, Triple E offers the amenities and living space to enhance each experience along the way.

EMPRESS



Heavenly Pursuits

If life is about the journey and not the destination, then Empress Elite voyagers have already arrived! Powered by a Cummins ISL 425 diesel engine on a full air ride Freightliner chassis with independent front suspension. Passengers enjoy its abundant amenities, spacious interior and distinctive furnishings.



INVITATION



Let the Good Times Roll

Here's an Invitation to follow your dreams! Hit the road to pursue your passions. With an available 400 HP Cummins diesel and Allison six-speed automatic transmission as well as a dazzling array of driving features, Invitation will take you to your dream destinations in safety, comfort and style.



SIGNATURE



Refined Living

Hit the highway in high style with our newest model, the unmistakable Signature. This coach makes a luxury statement inside and out. Floating on Air Suspension, the Signature is a 37' vacation home powered along by a Cummins Engine in a Freightliner chassis. All the remarkable comforts of refined living on the road.



COMMANDER



Make your getaway

Commander makes it possible to leave your worries behind while taking the comforts of home with you. From end to end, you'll find a surprisingly large amount of storage space and thoughtful features designed for your comfort and convenience. **Now available in gas or diesel.**



NOTES

Blank lined area for notes.



Triple E

TRIPLE-E

WWW.OCOONORRV.COM



living for today!

EMBASSY



Travel in deluxe comfort

Journey in the lap of luxury in the tastefully-appointed Embassy, which features even more creature comforts and more amenities for 2008. From the reclining seats to the wood-framed refreshment centre to the home stereo and DVD player, no detail has been overlooked. The Embassy makes the trip as exciting as the destination.

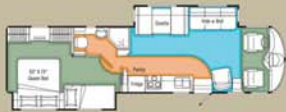

REGENCY GT



Dream big, live large

Wherever the road may lead you, go first class in Regency GT. Designed for couples or small families who need a compact motor home but want to travel in style, Regency GT offers several distinct design features, including finely crafted Alderwood cabinetry and luxurious furnishings.



TOPAZ Travel



What a Way to Go

Indulge in the pleasure of choosing your own view through large, thermo pane windows that accentuate the pleasant, bright interior. A generous galley provides preparation space for that delicious meal, and the comfortable hide-a-bed always allows room for overnight guests.



TOPAZ 5th Wheel



Living for Today

When your lifestyle includes exploring fresh landscapes along the open road, Topaz offers the amenities and living space to enhance each experience along the way. Modern appliances, crafted oak woodwork, fresh colour and fabric choices testify that no detail has been overlooked.



NOTES

Blank lined area for notes.

Triple E



TRIPLE-E

WWW.OCONNORRV.COM

8

see the country without leaving home.

PROVIDENCE



Some people have a keen appreciation for the finer things in life. And Providence is definitely one of the finer things.

Standard features include: Lush fabrics. Natural wood grained cabinetry and crown molding throughout the coach. Samsung LCD HDTV. Cummins 360HP diesel engine.



BOUNDER DIESEL

The Bounder Diesel has it all: a choice of spacious floor plans with triple, quad and full wall slide-outs, an impressive galley, comfy furnishings, and lots of storage.

Why buy a Bounder Diesel? Well designed floor plans. Quality components from carpeting to cabinetry, sofas to light fixtures. Superior ride and handling with a powerful Cummins 325HP diesel engine.



TERRA LX



The Terra LX practically makes your heart skip a beat. Exceptionally beautiful both inside and out, you'll be proud to show it off wherever you go. The Terra LX boasts the high-quality construction and upscale features usually found in coaches that sell for thousands more.

Family - Friendly Design Lots of interior coach room. Tons of storage. Private bedroom suite for mom and dad.



SOUTHWIND

When it comes to weekends, Southwind makes those two days worth the other five. After a day of fishing on the river, you'll enjoy the crystal-clear TV and spacious bed. The galley holds all your favorite snacks behind beautiful cabinetry. Contemporary styling, comfortable furniture and brand name appliances. Full-body paint and striking exterior graphics.



NOTES

Handwritten notes area with horizontal lines.

FLEETWOOD

WWW.OCONNORRV.COM



REGAL

Enjoy the royal treatment in the Regal. Live like royalty wherever you are in your Regal. A spacious galley, large bed and big refrigerator means you are the king of your castle. In short, Regal is designed for functional comfort and long-term stays.

Luxury features include:

- Queen-size comfortable, innerspring mattress in master bedroom
- Master bath spacious enough to hold a marble-finish shower and sink
- Guest bedroom roomy enough for a full size bed and overhead bunk



Separate guest bathroom available
 Also available on some models:
 fireplace, washer/dryer, flat screen TV
 and larger refrigerator
 No matter how many in your family, you'll find the plan that gives everybody enough space. Superior construction materials and outstanding workmanship are always standing in every Fleetwood towable.



PIONEER



PROWLER

Prowler is one of the top-selling towable trailer brands of all time. We offer a very wide range of well-designed floor plan configurations to suit up to twelve people.



Camp like you did when you were a kid, but without the dirt in your sleeping bag. Pioneer trailers are an affordable luxury you will enjoy. Plenty of room for the whole gang and lots of storage capacity make this family friendly travel trailer a must see on your towable search.



NOTES

Fleetwood

FLEETWOOD

WWW.OCONNORRV.COM

British Columbia RV Regulations Compiled by RVDA of Canada

RV Regulations

Maximum Length		Vehicle Combination		Max Height	Max Width	Passengers in Towed Vehicle	Passengers in Seat Belts	Propane on While Travelling	Passengers Allowed in Truck/ Camper
Motor Homes	Towables	Max Length	No. of Units						
14m	12.5m	20m	2	4.15m	2.6m	No	Yes	Yes	No

Driver's License Regulations

Thanks to a reciprocity agreement between the provinces, if you are properly licensed in your home province, you may drive in other provinces or states without worry. You do not need to meet the qualifications for every other jurisdiction you visit in your travels. British Columbia

permits the operation of any two-axle vehicle including cars, vans, trucks and utility vehicles. You may also operate motorhomes (including those with more than two axles) as long as the trailer being towed is 4,600 kg or less. Above this weight you will need a Class 4 or Class 5 license with a heavy trailer endorsement (Code 51).

British Columbia Trailer Brake Requirements

- Gross trailer weight of 1,400 kg (3,080 lbs) or less - Brakes are required if the trailer and its load weigh more than 50% of the licensed weight of the vehicle towing it.
- Gross trailer weight of 1,401 kg (3,081 lbs) to 2,800 kg (6,160 lbs) - Brakes are required, including a breakaway brake.
- Gross trailer weight of more than 2,800 kg (6,160 lbs) - Brakes are required, and the trailer brakes must be

capable of being applied by the driver independently of the towing vehicle's brakes. A surge brake does NOT meet this requirement. A breakaway brake is also required. Brakes are required on all axles.

The sole exemption to this rule is for a 3 axle house trailer, in which case brakes are only required on 2 of the 3 axles.

Towing Dolly Brake Requirements

- Gross weight of dolly and motor vehicle carried is 1,400 kg (3,081 lbs) or less.
- Brakes are not required on the dolly if the net weight of dolly plus (+) the gross weight of motor vehicle carried plus (+) the gross weight of tow vehicle equals (=) less than the gross vehicle

weight rating of the towing vehicle.

- Combinations other than the two outlined above require brakes on the towing dolly. Brakes are not required on the motor vehicle being carried by the dolly.

Tow Bar Brake Requirements

- Motorhome and Towed Motor Vehicle - If the towed motor vehicle has a gross vehicle weight of less than 2,000 kg (4,400 lbs) and is less than 40% of the gross vehicle weight rating of the motorhome, brakes and coordinated brake control are not required.
- Commercial Vehicle with GVWR over 5,500 kg (12,100 lbs) and Towed Motor Vehicle - If the aggregate weight of the combination does not

exceed the GVWR of the commercial vehicle brakes are not required on the motor vehicle being towed.

- Other Combinations - If the combination is not included in the two situations outlined above, brakes are required on all wheels of the motor vehicle being towed in the same manner as trailer brake requirements.

General Brake Requirements

- Brakes with which a trailer is equipped when applied must be adequate to maintain control of the trailer; when applied must not affect the direction of travel of the trailer.
- Breakaway Brake Must automatically apply when the trailer separates from the tow vehicle and when applied must be capable of remaining fully

applied for at least 15 minutes.

Detached Trailers

- No person shall park or leave a detached trailer at any place on a highway unless the wheels are locked so that the trailer will remain stationary at that place

So What is RVing?

We'll let you in on a little secret: RVing is about taking control of your vacations and weekends in a whole new world of freedom and relaxation. Go where you want, when you want, Turn every weekend into a mini-vacation, every trip into a hassle-free escape.



Towing Guide

TOWING GUIDE

PRESENTED BY O'CONNOR RV

Carriage *the world's finest 5th wheels!*



CAMEO 35SB3

The 2008 Cameo 35SB3 featured in our new Glazed Maple with the Celery decor package. The spacious living and kitchen arrangements allow for ease of entertaining and the island provides ample storage. The 80-inch sofa and dual-reclining loveseat both have great viewing angles for the standard Samsung LCD television. 2 folding chairs (not shown) are standard furniture for additional dining seating, and the table contains a hidden leaf that quickly enlarges the table for dinner or card playing.



CAMEO 34CK3

The 2008 Cameo 34CK3, shown with our Cherry wood and the Espresso decor package. The DVD/stereo is hidden above the LCD television to provide for the larger desktop workspace. A file drawer is also provided for full-time convenience. Note the kitchen cabinets reach all the way to the ceiling, maximizing kitchen storage in a mid-kitchen arrangement.



CARRI-LITE CL36SBQ

The 2008 Carri-Lite Now this is really living! Carri-Lite 5th Wheels are carefully tailored to meet the needs of today's RVer. Island kitchens, an abundance of storage, spacious bathrooms and upscale interiors are all standard features to the Carri-Lite line. A full range of Emerald upgrades are available including larger slide windows and dual-pane ceiling windows.



DOMANI DF300

The 2008 Domani DF300 The new Domani is both a work of art and state-of-the-art. The distinctive contemporary styling inspired by the Luxury Auto and Yachting Industry is exclusively Domani. No other fifth wheel comes close to the rich, luxurious and lavish feel you get from the Domani. The Domani is the first and only true luxury lightweight fifth wheel available.



Cameo



Domani

Carriage

NOTES

CARRIAGE

WWW.OCONNORRV.COM

2 Planning an RV vacation is easier than you might think.

Recreational vehicle (RV) owners know that vacationing in an RV offers more value for the dollar than almost any other vacation. Instead of staying in hotels and dining in restaurants, "RVers" travel in ease and comfort, knowing that they can truly enjoy their vacation on the road without the hassles.

There are two basic types of RVs - motorized and towable. Motorized RVs, such as motor homes and camper

vans, come equipped with all of the features found in standard passenger vehicles, such as power steering and fuel-injected engines. Most motor homes include all of the comforts of a modern home, such as air conditioning and multi-speaker stereo system - some even feature a central vacuum and built-in safe for storing valuables.

Towables require a separate vehicle for travelling on the road. If you own a pick-up truck, van, sport utility vehicle or even a full-size car, you're already set.

While you're shopping for an RV, don't forget to look for the two seals from the Canadian Standards Association (CSA) and the Canadian Recreational Vehicle Association (CRVA). These two organizations work together to ensure the highest construction and safety standards.

The best way to determine the ideal RV for you is to first consider how many people you'll be travelling with and for how long. Discuss it with your sales professional, who will be able to give you

expert advice on what size and type of RV is best suited to your family's size and budget.

RV camping is fast-paced fun but it's also a lesson in living with nature, working together as a family, sharing and giving. You can visit museums that will spark the kids' interest in dinosaurs or space travel, watch the tides at the seashore or learn how to start a rock collection. The options are almost limitless when you're vacationing in an RV. As ages go up, so do opportunities to savour

travel's pleasures, spend time with grandchildren and make new friends.

Wherever you decide to visit on your excursion, you'll appreciate the comfort and convenience of travelling with an RV and making your house on wheels into a home on wheels.

For more information on the RV lifestyle call 1-888-Go RVing (467-8464) or log on to www.GoRVing.ca for a free brochure



Freedom to fully enjoy life

is a luxury acquired with success and by attaining peace of mind knowing your properties and valuables are well protected...

HOME/TRAVEL

- Reconstruction coverage
- Personal property coverage
- Personal liability insurance
- Customized Travel Insurance

BUSINESS

- General insurance
- Property coverage
- Crime coverage
- Custom policies



AUTO

- Worldwide liability
- Rental car
- Full glass
- Towing & labour
- Uninsured or underinsured coverage

TOYS

- Full value in the event of a loss
- All risks coverage
- Knowledgeable, prompt, quality service from your insurance broker

...HUB International Barton Insurance can help.

54 branches throughout BC. Call or click for a HUB International Insurance Broker nearest you. 1 - 800 - 668 - 2112 www.hubinternational.com

Finance Your RV Purchase

Financing gives you the benefit of low monthly payments at competitive interest rates. We deal with most local banks and credit unions, please feel free to contact us for details.

- ✓ Loans purchased through O'Connor Financial Services are open agreements. That means you can make an extra payment, or pay it off at anytime without penalty. The interest rates are fixed, which means that the payment will never go up and the term will never change.
- ✓ Our Loans can be tailored to your individual needs with various terms available and flexible down payments.
- ✓ And just like home mortgages, we offer life protection as well as illness and injury protection.
- ✓ But the best part of all is the interest rates; O'Connor Financial Services offer loans with interest rates that are generally lower than your own financial institution.



NORTHERN Lite *innovative craftsmanship!*



Man has never been able to improve on the many wonders of nature which the Northern Lights (Aurora Borealis) epitomizes. Northern Lite's innovative design and engineering has resulted in an ultra-light camper, structurally laminated and aerodynamically crafted, to give maximum strength and insulation properties. Its richly polished natural oak interiors blend with fine upholstery and decorator wall panels. These creative designs are easily adaptable to all makes and models of imports and domestic trucks. These new campers again demonstrate Northern Lite's "Personal Care and Quality Workmanship." We are constantly striving for excellence. Proudly Canadian, the logo, a pair of Canada geese, symbolize traveling companions for life.



SPECIAL EDITION

Distinctive Features 10'2" CD Special Edition

- Upgrade Dometic thermal pane acrylic windows
- 10' Side awning
- 4000R Fantastic Fan
- Additional battery box
- Battery disconnect switch
- Sliding propane tray
- Rear bumper c/w step
- Electric jacks
- Removable carpet
- Prewire for solar panel
- 3-Way switch for bunk lights
- Stereo CD/DVD player
- LCD television c/w antenna
- Dometic lighted skylight/escape hatch
- Domestic microwave
- Overdoor Awning
- Privacy drape
- Bedspread, pillow and shams
- Roof air conditioner
- Solid hardwood cabinets
- Only weighs 2980 lbs.



NOTES



NORTHERNLITE

WWW.OCONNORRV.COM



At Forest River, our design team is always working towards improving the Toyhauler of tomorrow.



THE SANDSTORM SERIES

Toy Haulers To Fit Your RV Fun!

Forest River, has been producing quality multi-utility RVs for over 10 years and is considered one of the pioneers in the industry. Manufacturer of the popular Sandstorm 5th Wheel toy haulers and 1/2 Ton Wide Body toy haulers, Forest River understands every RV enthusiast has different needs. They offer a versatile array of floor plans and features to choose from. Quality features such as designer decor, am/fm cd with MP3 input, solid wood drawers, huge storage capacity with room for quads, side by side in the rear are all standard issue when it comes to the Sandstorm series. Longevity, utility, value and loyal customers are the reasons Forest River is an important part of the O'Connor line-up.

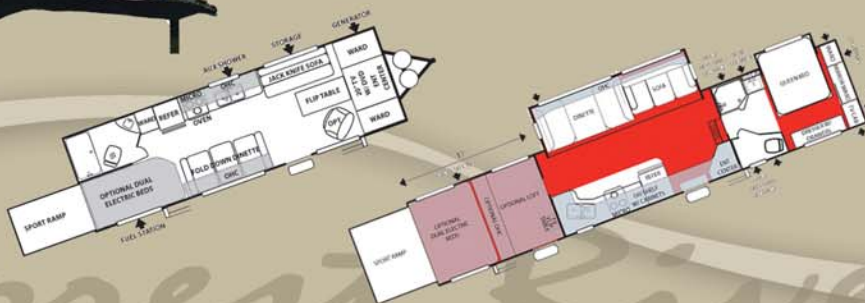

NOTES

FOREST RIVER

WWW.OCONNORRV.COM



Pleasure-Way



CHEVROLET Lexor



FORD Excel



DODGE Plateau

The Lexor

Adventurers, hit the scenic highways in the Pleasure-Way Lexor built on the Chevrolet Express chassis. The sumptuous feel of Ultra Leather® front seats and a 155 inch wheel base makes this motorhome feel more like a luxury automobile. The nimble and responsive handling makes driving and parking easy even to an apprentice. In our cleverly designed kitchen, the

stove cover doubles as a slide out counter extension and the flexible bathroom allows you privacy when you need it. For a quick weekend get away or a cross county excursion, the only person you'll have to answer to is the open road.... Pleasure-Way Lexor.

The Excel

Inspired by old world craftsmanship, the interior of the Excel

Wide Body is hand crafted piece by piece showcasing the intricate detail of rich hardwood fluted maple moldings and solid arched maple cabinetry doors that warm the interior of the coach. Elegant design and the upscale residential feel of the Excel is reflected in the beautiful Corian® countertops and opulent Ultra Leather® Fabrics. Dim the flush mount halogen lights and enjoy your favorite movie on the LCD HD ready TV. With over twenty years experience in building

only Class B Motorhomes, Pleasure-Way's cornerstone of success is an unwavering commitment to the highest quality without compromise. You have come to expect no less... Pleasure-Way Excel.

The Plateau

Imagine a Motorhome built with intensive meticulous craftsmanship and powered by Mercedes Benz, this culminates in the finest diesel Class B Motorhome possible. Striking a balance between sleek and modern

radius cabinetry with the form and function of custom shaped Corian® countertops and luxurious Ultra Leather® Fabrics, you will redefine your expectations. Reflect your personal style by choosing between a selection of three Ultra Leather® Fabrics and maple cabinetry colors. Sink into your rear sofa as the layer of memory foam shapes to your body. You have worked hard, don't compromise, you deserve the best.... Pleasure-Way Plateau.

For more information on Pleasure-Way Class B Motorhome
www.pleasureway.com

NOTES

Pleasureway

PLEASURE-WAY

WWW.CONNORRV.COM



New O'Connor Collision building dedicated to RV repairs.

"Everything We Do is Driven by You"

O'Connor Dodge Chrysler Jeep



Whether you are one of our loyal, local customers or one of the hundreds of visitors that we see each year, you'll be impressed with our friendly atmosphere and large inventory of new Dodge, Chrysler and Jeep products, as well as quality pre-owned & lease return vehicles.

O'Connor Dodge Chrysler Jeep is proud to offer one of the most up to date and efficient full-service vehicle dealerships in the province of British Columbia. We offer new Dodge, Chrysler and Jeep vehicles as well as quality pre-owned cars, trucks and sport utilities.

Our facility is equipped with a state of the art service centre, as well as a 40' RV hoist for mechanical repairs. Visit our complete parts department for your Dodge, Chrysler and Jeep vehicle.



www.oconnorgroup.biz

O'Connor Collision Towing & Glass



Collision

Our main focus at O'Connor Collision is just that, collision. Our collision services restore your car to factory condition or better. We repair vehicles with major or minor damage and guarantee our work

Towing

O'Connor Towing is ready to serve you any time of day or night. We provide recovery service and roadside assistance. We offer 24/7 truck availability to tow your vehicle to our shop, your home or anywhere.



info@oconnorcollision.com



We Use Only **EARTH FRIENDLY** Automotive Paints



Glass

O'Connor's glass services are second to none. Whether broken in an accident or just chipped by a rock, we are happy to replace any windows on your vehicle. We perform all glass services on site, some while you wait



DODGE CHRYSLER-JEEP 604-792-2754
45730 HOCKING AVE
CHILLIWACK, BC



COLLISION TOWING & GLASS 604-792-3170
44840 YALE ROAD WEST
CHILLIWACK, BC