



Black Gold Cabernet Gold Cafe Blanc Claret Pearl Mocha Frost Vienna Night

2011  
*American*  
**TRADITION**

Not all exterior colors or graphics are shown. All colors are available in Latitude and Legion graphics schemes. See your American Coach dealer or visit our website at [www.AmericanCoach.com](http://www.AmericanCoach.com) to view all graphic and color choices.

INTERIOR DÉCORS

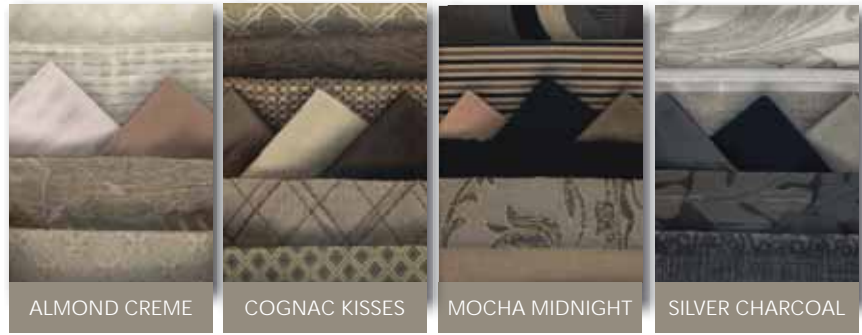

ALMOND CREME COGNAC KISSES MOCHA MIDNIGHT SILVER CHARCOAL

WOOD FINISHES



ALMOND MOCHA GLAZE REGENCY CHERRY W/EBONY GLAZE MAHOGANY



TRADITION  
TOP FEATURES:

- Villa Furniture
- Quiet Air Conditioning System
- Porcelain Tiled Floors Throughout
- Avionics Entry Door
- Dual Dash Monitors
- Power Driver Window
- Liberty Chassis
- 30" Slides For Unmatched Floor Space
- Sony<sup>®</sup> Blu Ray Home Theater

42P

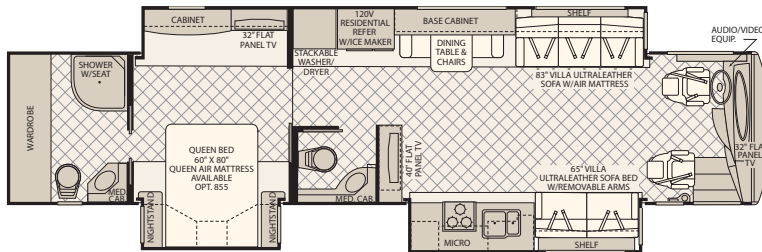

Available options: 107, 113, 124, 125, 126, 127, 129, 205, 828, 852, 855, 856, 881

42M

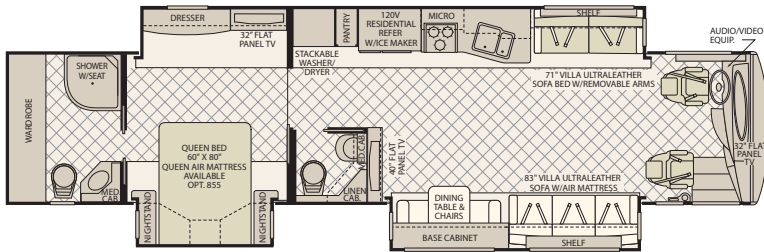

Available options: 107, 113, 124, 125, 126, 127, 129, 205, 828, 852, 855, 856, 881

45Y

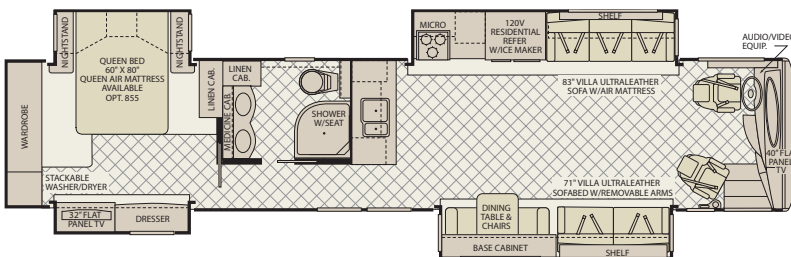

Available options: 107, 113, 124, 126, 127, 129, 828, 852, 855, 856, 881

OPTIONS

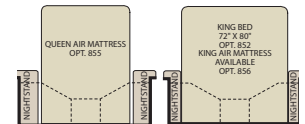
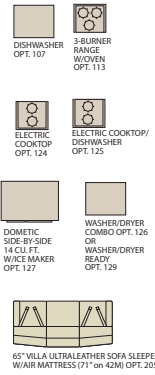

Seatbelt configuration may vary depending on options chosen.

## WEIGHTS AND MEASUREMENTS:

WEIGHTS	42M	42P	45Y
GVWR (lbs) <sup>1</sup>	46,600	46,600	46,600
Front GAWR (lbs) <sup>2</sup>	16,600	16,600	16,600
Rear GAWR (lbs) <sup>2</sup>	20,000	20,000	20,000
Tag Axle GAWR (lbs) <sup>2</sup>	10,000	10,000	10,000
GCWR (lbs) <sup>3</sup>	61,600	61,600	61,600
Hitch Rating Weight (lbs) <sup>†</sup>	15,000	15,000	15,000
Tongue Weight (lbs) <sup>†</sup>	1,500	1,500	1,500

DIMENSIONS & CAPACITIES	42M	42P	45Y
Wheelbase (inches)	302"	302"	302"
Overall Length <sup>4</sup>	42' 11.5"	42' 11.5"	44' 11.5"
Overall Height (with A/C)	13' 2.25"	13' 2.25"	13' 2.25"
Overall Width (maximum) <sup>5,6</sup>	102"	102"	102"
Interior Height (maximum)	84"	84"	84"
Interior Width (maximum)	96"	96"	96"
Fresh Water Holding Tank (gal)	100	100	100
Grey Water Holding Tank (gal)	60	60	60
Black Water Holding Tank (gal)	40	40	40
Appliance Propane Tank (gal) (WC) <sup>7</sup>	28.2	28.2	28.2
Fuel Capacity (gal)	150	150	150
Std. Carefree Patio Awnings	19' 6"	17' 6"	19' 6"
Opt. Girard Patio Awnings	13' 4"	12' 5"	12' 5"

Liquid Weight Reference: Water (gal) = (8.3 lbs/3.8 kgs) Fuel (gal) = (6.1 lbs/2.8 kgs)  
 Propane (gal) = (4.2 lbs/1.9 kgs)  
 Metric Conversion: Multiply pounds x 0.453 to obtain kilograms. Multiply gallons x 3.785 to obtain liters.  
 Multiply liters x 61 to obtain cubic inches.

CHASSIS - CUMMINS® 425	CHASSIS - CUMMINS® 450 (New Emission)
<b>Frame:</b> Liberty Chassis	<b>Frame:</b> Liberty Chassis
<b>Engine:</b> ISL 425 HP, 8.9L w/2 Stage Engine Brake	<b>Engine:</b> ISL 450 HP, 8.9L w/2 Stage Engine Brake
<b>Torque:</b> 1200 lb-ft @ 1300 RPM	<b>Torque:</b> 1250 lb-ft @ 1300 RPM
<b>Transmission:</b> Allison® 3000 MH, 6 Speed w/Electronic Shifter	<b>Transmission:</b> Allison® 3000 MH, 6 Speed w/Electronic Shifter
<b>Alternator Amps:</b> 200 Amp, Leece Neville	<b>Alternator Amps:</b> 200 Amp, Leece Neville
<b>Tires:</b> 315/80R 22.5 Michelin® Radial (2)	<b>Tires:</b> 315/80R 22.5 Michelin® Radial (2)
<b>Tires:</b> 295/80R 22.5 Michelin® Radial (6)	<b>Tires:</b> 295/80R 22.5 Michelin® Radial (6)

- GVWR (Gross Vehicle Weight Rating) is the maximum permissible weight of this fully loaded motor home. The GVWR is equal to or greater than the sum of the (UVW) unloaded vehicle weight plus the (OCCC) occupant cargo carrying capacity<sup>8</sup>.
  - GAWR (Gross Axle Weight Rating) is the maximum permissible loaded weight a specific axle is designed to carry.
  - GCWR (Gross Combined Weight Rating) is the value specified by the motor home manufacturer as the maximum allowable loaded weight of this motor home with its towed vehicle. Towing and braking capacities may be different. Refer to Fleetwood RV and chassis manufacturer's manuals for complete information.
  - Length measured from front bumper to rear bumper (excludes accessories).
  - Excludes safety equipment and awnings.
  - Motor homes feature a body-width over 96" which will restrict your access to certain roads. Before purchasing, you should research any state and/or province road laws which may affect your usage.
  - Tank manufacturer's listed water capacity (WC). Actual propane capacity is 80% of water listing as required by the safety code.
- † The chassis manufacturer recommends the installation of a supplemental brake control system to activate the brakes on the vehicle or trailer you are towing. Hitch receiver ratings expressed are maximum for the hitch receiver installed and may require the purchase of additional equipment that is dependent on the weight of the towed load. Consult with hitch receiver manufacturer for further information.

UVW and OCCC are found on the label containing the federal certification tag in each RV.

## WHY AMERICAN COACH?



### Quality

There's no cutting corners. Skilled craftsmen build every American Coach for maximum durability and longevity.



### Trust

More people trust American Coach. After all, we've spent the last 60 years perfecting RVs, earning the loyalty of generations of RVers.



### Passion

We're truly passionate about the RV lifestyle. American Coach was founded by RV enthusiasts, and that tradition continues today.



### Safety

You've got precious cargo. So we've engineered dozens of innovative safety features into our motor homes to give you more peace of mind.



### Service

Help is nearby with 24/7 emergency roadside assistance through **Coach-Net**®\*. And when you need an upgrade or repair, you'll find American Coach dealers all across North America ready to assist you.



### Warranty

Exclusive RV Ownercare warranty. See your American Coach dealer for details.

## RV OWNERCARE\*

Limited one-year/15,000-mile coach warranty and three-year/45,000-mile structural warranty, whichever occurs first, and it is fully transferable for the first 12 months. RV OWNERCARE is one of the RV industry's most comprehensive programs and includes systems, appliances, components and construction, with no deductible and no service charge. RV OWNERCARE coverage is provided from a company that will be around in the future to service your needs. See your nearest American Coach dealer for a full explanation of benefits and restrictions.

## CONTACT US

To locate a dealer near you, visit our website at [www.americancoach.com](http://www.americancoach.com) or call 1-800-322-8216. We can also be contacted at American Coach Customer Relations, P.O. Box 1007, Decatur, IN 46733.

## AMERICAN COACH OWNERS

As a American Coach owner, you're invited to become a member of several American Coach motor home clubs. Becoming a club member is the perfect way to meet other American Coach owners who love to travel across America and share in the RV lifestyle. Visit our website at [www.americancoach.com/owners\\_clubs](http://www.americancoach.com/owners_clubs) to learn more and join the fun.

## IMPORTANT—PLEASE READ

Product information, photography and illustrations included in this publication were as accurate as possible at the time of printing. For further product information and changes, please visit our website at [www.americancoach.com](http://www.americancoach.com) or contact your local American Coach dealer. Prices, materials, design and specifications are subject to change without notice. All weights, fuel, liquid capacities and dimensions are approximate. American Coach has designed its recreational vehicles to provide a variety of uses for customers. Each vehicle features optimal seating, sleeping, storage and fluid capacities. The user is responsible for selecting the proper combination of loads (i.e. occupants, equipment, fluids, cargo, etc.) to ensure that the vehicle's capacities are not exceeded.

\*All 2011 American Coach motor homes include a 1-year membership to Coach-Net.

